

Quick Guide

Velo



Ordnance
Survey

Data Page (1/4)

Chronometer

01:45:52

Odometer (Mi)

8.6

Ascent (ft)

2850

Mean Speed (MPH)

4.8

Descent (ft)

1980

Profile Odometer (Mi)

256

Device layout

Lock button :

Short press: Lock GPS /
Unlock GPS

Map:

Press on the map to
activate the tools

Data bar:

Press to access the data
pages

Main menu:

Manage files and settings
on your device

Start / Pause button:

Short press: Start activity
/ Pause activity
Long press: Mark lap

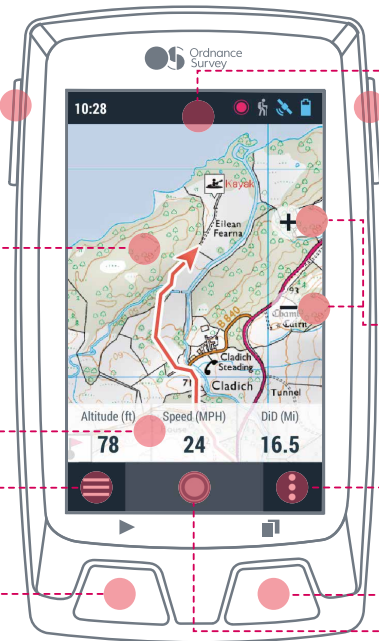

Status menu:

Press to check the status
of the most frequently
used features (sensors,
GPS...)

Power button:

Long press: Turn GPS on /
Turn GPS off

Zoom:

Press + to zoom in and -
to zoom out of the map

Contextual menu:

Press to access options
available for the current
page

Page button:

Short press: Show next
data page

Activity control:

Start, pause and finish an
activity

1

Get Started

Before you turn on your Velo* you'll need to register it with an **OS Shop** account.

To register your device go to:

os.uk/gpssetup

**Your device may need charging before you start. Using the charger inside your box, plug it into the mains and if a battery with a lightning bolt appears, leave it to charge.*

2

To complete the registration process you'll need to input your devices **Serial Number (S/N)**.

To find your **S/N** you'll need to:

1. Turn your device over so you can see the back.
2. Find your S/N on the sticker at the bottom.

Once you've registered your GPS you'll be sent a confirmation email from TwoNav, which will include your username and password to set up SeeMe and GO.

3

Now you've registered your Velo, you'll be able to get your **6** free map tiles and buy any additional ones via **My OS GPS**, under your **OS Shop** account.

To get tiles click on the **Buy Maps** tab, select between 1:25k and 1:50k scales, drag your mouse around the map and select the tiles you want, click **Confirm list selection** then **Proceed to checkout**.

Follow the on-screen instructions and once your transaction is completed, click on the **head here to install it on your device** link and you'll be redirected back to **My OS GPS**.

4

To get your map tiles onto your device you'll need to download them.

To do this click on the **Maps ready to download** tab under **My OS GPS**.

Connect your device to your computer using the **USB cable** inside your box.

Click on the **Download** button next to your map tile(s) and follow the on-screen instructions*.

**when downloading map tiles for the first time, you'll need to download the downloader onto your computer.*

5

Now that you've registered your Velo and downloaded your map tiles, you're ready to turn it on.

Disconnect your USB cable, then **press down on the Power button to turn your device on.**

Once turned on make sure you connect your GPS to **Wi-Fi** and download and install the **latest software updates.**

You may want to adjust the screen brightness when turning your device on for the first time, by pressing **Status menu > Brightness.**

6

It's important that you have a good GPS signal before you start.

Stand outside in an open area to connect to as many satellites as possible – check the status by pressing **Status menu > GPS > Status = GPS Fixed.**

When the connection is ready, the  icon will turn blue at the top of the home screen.

On setup you may also need to calibrate the compass and barometer. **Press Menu > Settings > System > Calibration > Follow the on-screen instructions.**

Get Going

Now that you've registered and set up your device, you're ready to get outdoors and go on an adventure.

Your Velo will give you the freedom to go further, with a number of fantastic features to help you explore!

Start an activity

From the home screen, press on the **Start** button to see a list of all activities, then select the one you want to do. Activities include:

Free Activity: Your GPS will record your routes and waypoints.

Follow a Route / Activity: Follow routes you've downloaded to your device from OS Maps or Strava™, or follow a previous activity you've done.

TrackAttack: Train against yourself by going up against your previous efforts.

Training by Distance / Time: Get the most out of every activity, by training against distance or time.

Track your data

Your Velo tracks route and activity data in real-time and can track more than 120 different pieces of data.

To view your data in real-time, press on the **data fields** at the bottom of your map, then use the arrows to scroll between the pages.

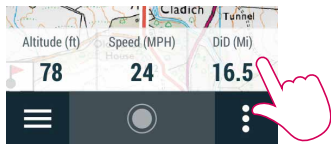

View your activities, routes and waypoints

All of your activities, routes and maps are saved onto your GPS, where you can access them whenever you want.

On the home screen press the **☰** button to bring up the menu, where you can access your saved data and device settings.

To view your activity data, press on **My Activities**, choose the activity you want to look at and scroll through the information.

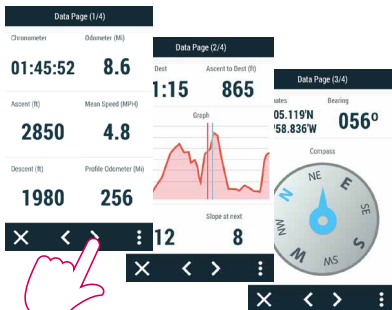

GetOutside

Now that you've gotten to grips with your Velo,
you're ready to go.

If you need inspiration for your next adventure,
head over to:

[GetOutside.uk](https://www.getoutside.uk)

Bundled Extras

Your Velo comes with bundled extras including
SeeMe and OS Maps Digital - set them up now to
get the most out of your device.

SeeMe – location sharing

Your device comes with a 6-month free subscription to SeeMe. Use SeeMe to broadcast your location with friends and family in real-time and send your emergency contacts your exact location should you get into trouble.

To set up SeeMe, log in to your **OS Shop account**, click **My OS GPS**, then under **My devices** click the **Go to SeeMe** button, then the **Get started now** button – to log in you'll need to use the login details sent to you by email from TwoNav, when you first registered your GPS.

Before starting an adventure you'll need to make sure SeeMe is activated on your device. Press on the **Status menu**, scroll down and check the **Broadcast** icon is blue and says **Active** and the **Emergency** icon is blue and says **Ready**.

OS Maps – sync your routes

Redeem your free 3-year subscription to OS Maps using the voucher code inside your box. Use OS Maps to find, plot and sync routes to your GPS - to access routes on your device, you'll need to:

1. Ensure Wi-Fi is on and connected.
2. Go to **Settings > My Accounts > Add New Account > Ordnance Survey user**, then enter your OS Maps username (email) and password.
3. To see your routes, press **Menu > Routes > > Online Routes > Ordnance Survey** folder, where you will be able to see your routes – this may take a couple of minutes the first time.
4. To save your routes offline, press on them and they will download to your device where they will be marked with a tick.
5. Your routes will now appear under **Routes** in the main menu.

Sync your activities with GO and Strava™

Use the GO Cloud to sync your routes and data with GO (by TwoNav), to manage your activities on your computer.

Link the same data to Strava and share your achievements with others.

Get started with GO

The GO Cloud is your very own virtual storage space that automatically syncs and saves your activities to GO (whenever your GPS is connected to Wi-Fi), so that you can view them on your computer through GO and manage your data, routes and achievements.

To get started, you'll need to first log in to GO. Visit www.go.twonav.com and use the login details sent to you by TwoNav via email, when you first registered your Velo (these are the same login details used to set up SeeMe).

To set your device up with the GO Cloud, connect to Wi-Fi then press  > **Settings** > **My Accounts** > **Add New Account** > **TwoNav User** > **Log in** > then enter the same login details you used to access GO.

Sync with Strava™

Once connected to the GO Cloud (see previous page), you'll be able to sync your data with Strava™ and upload new activities to the largest online community for cyclists, runners and athletes.

To connect your GO Cloud with Strava™ **log in to GO** – www.go.twonav.com – **click on your username** in the top right corner, **click Settings** and then **Connect** to Strava™.

As soon as the accounts are linked, any new activities will automatically be uploaded to Strava™, as soon as they are synced with the GO Cloud.

Accessories

As well as the QuickLock bike mounts that come with your device, you can also buy additional accessories to track your performance and protect your GPS.

Your Velo comes with a **QuickLock Stem Bike Mount**, to attach it to your bike follow the images below:

1

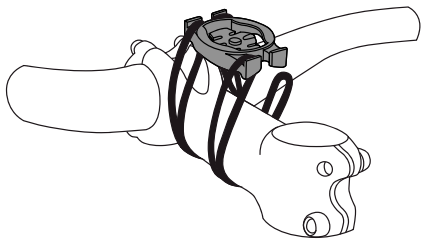

2

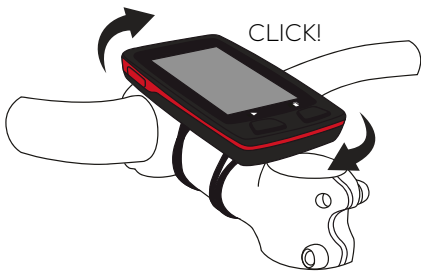

Your device also comes with a **QuickLock Upfront Bike Mount**, to attach it to your bike follow the images below:

1

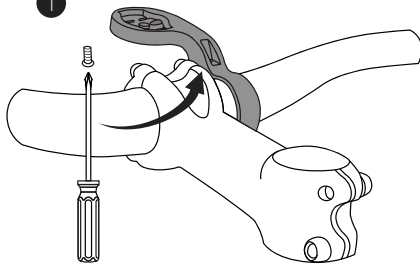

2

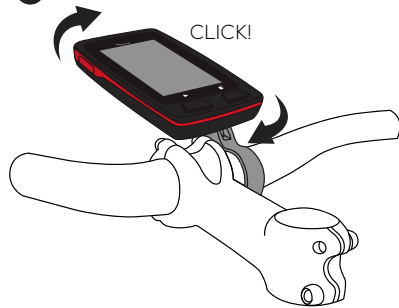

Connect additional sensors to your device using Ant+™ and Bluetooth® Smart, to get more insight from your activities and track performance.

Heart Rate Cadence Power Speed

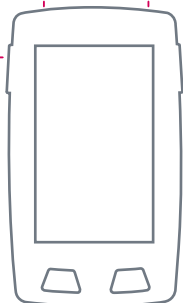

Warranty & Support

To see all OS accessories for your device, go to os.uk/gpsaccessories

Thank you for purchasing your Velo from Ordnance Survey. Now that you've completed your set up, you're ready to start your adventures with the freedom to go further.

For a full set of instructions, or if you've encountered any problems setting up your Velo, the following support is available:

Full manual (PDF download)

os.uk/gpssupport

'How to' videos (YouTube)

os.uk/gpssupport

FAQs

os.uk/gpssupport

Ordnance Survey Customer Service Centre:

Phone

03454 560420

Email

customerservices@osleisure.uk

Your Velo comes with a 24 months manufacturer's warranty provided by COMPEGPS TEAM SL. For information about your warranty please visit our website:

os.uk/gpssupport

My notes:



Ordnance Survey

Manufactured by:
COMPEGPS TEAM SL
Made in Spain

Powered by
TwoNav